

TECHNICAL SPECIFICATIONS

HSA1(B,Q)E Series

1.5 - 5 Ton Capacity

The HSA1(B,Q)E series of air conditioners offers exceptional performance. The unit, when combined with our engineered coils, offers a line of quality, 14 SEER split system cooling equipment.



FEATURES and BENEFITS

- **Composite Base Pan:** Absorbs sound and corrosion resistant. Composite is also stronger and lighter than steel.
- **Durable, Attractive Cabinet:** Designed using galvanized steel with a polyester urethane finish. The 950 hour salt spray finish is 1.5 mil thick and resists corrosion 50% better than comparable units.
- **Removable Top Grille Assembly:** Allows ease of service from the top without disconnecting fan motor leads.
- **High Pressure Switch:** Protects against abnormally high system pressures. Auto-reset feature prevents nuisance service visits.
- **Liquid Line Filter Drier:** Included with unit, field installed.
- **One Piece Top/Orifice:** Designed for maximum airflow and quiet operation.
- **Easy Compressor and Control Access:** Designed to make servicing easier for the contractor, access panels are provided to all controls and the compressor from the side of the unit.
- **Complete Metal Wrapper:** Durable metal guard protects the coil from yard hazards and extreme weather.
- **Anteater MC® Micro-Channel:** All aluminum coils in all models which provides high corrosion resistance.
- **Servicer-Friendly Jacket:** Side panels can be easily removed and replaced without removing the top grill.

MODEL IDENTIFICATION CODES

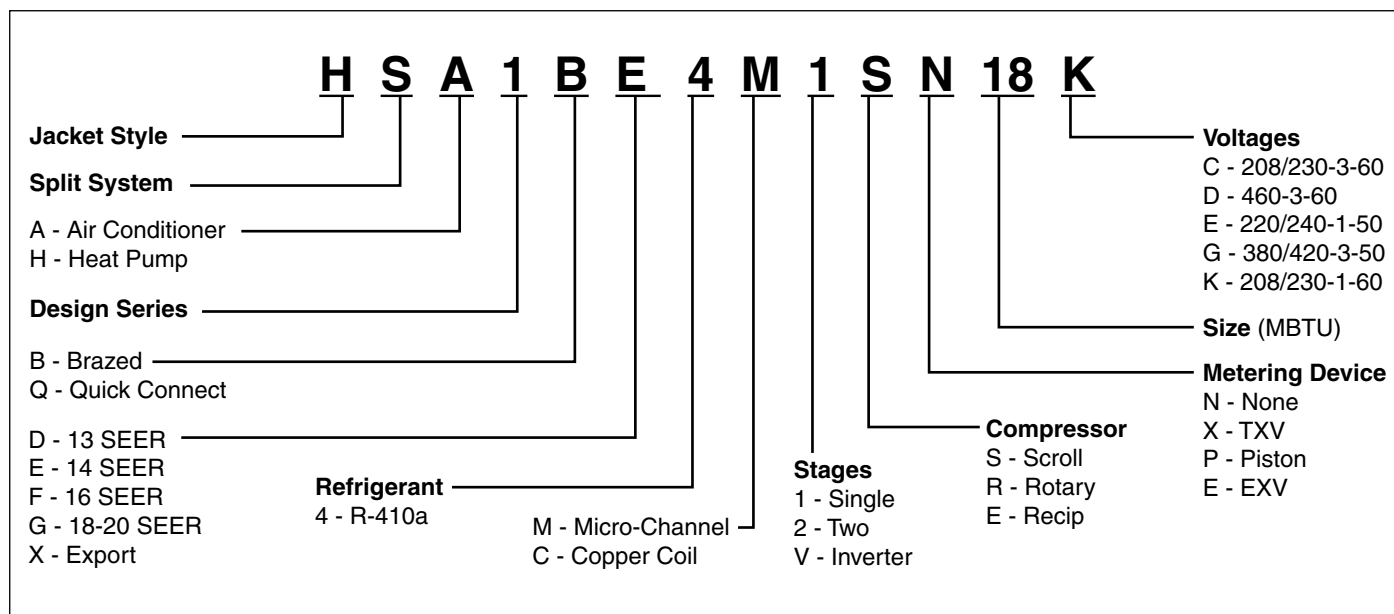

DIMENSIONS

AIR CONDITIONER OUTDOOR SECTION

HSA1(B,Q)E	18K	24K	30K	36K	42K	48K	60K
H	28.5	32.5	29.25	37.25	41.25	41.25	45.25
W	23.75	23.75	31.75	31.75	31.75	31.75	31.75
D	23.75	23.75	31.75	31.75	31.75	31.75	31.75

Air Discharge
Allow Adequate Clearance for Airflow

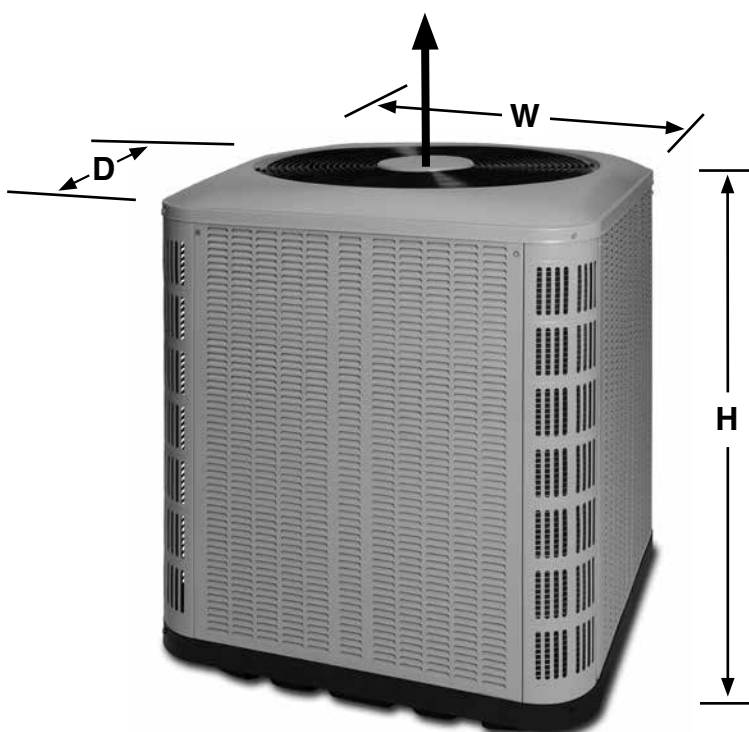

PHYSICAL AND ELECTRICAL SPECIFICATIONS / OUTDOOR UNITS

14 SEER — Extra High Efficiency — Single Phase

Model Number HSA1(B,Q)E			18K	24K	30K	36K	42K	48K	60K
Electrical Data	Volts-Cycles-Phase (1)		208/230-60-1						
	Total Amps		9.9	14.4	15.0	15.1	19.4	21.3	29.0
	Delay Fuse Max. (2)		20	30	30	30	40	45	60
	Min. Circuit Ampacity		12.1	17.7	18.5	18.6	23.9	26.3	35.6
Component Data	Fan Motor	Type	PSC						BLDC
		Amps	0.9	0.9	0.9	1.0	1.5	2.6	2.6
		HP	0.13	0.13	0.13	0.20	0.25	0.33	0.33
	Compressor Data	RLA	9.0	13.4	14.1	14.1	17.9	19.8	26.4
		LRA	48.0	58.3	73.0	77.0	112.0	109.0	134.0
Refrigerant suction line O.D. NOTE: Liquid line is 3/8" O.D. for entire length.		0-24 ft.	3/4"	3/4"	3/4"	3/4"	7/8"	7/8"	7/8"
		25-39 ft.	3/4"	3/4"	3/4"	7/8" (3)	7/8"	7/8"	1-1/8" (4)
		40-75 ft.	3/4"	3/4"	3/4"	7/8" (3)	7/8"	7/8"	1-1/8" (4)
Approximate Weight (lbs.)		Net	129	133	159	176	206	206	251
		Ship	138	141	169	187	218	218	264
Sound Rating dB			74	74	75	79	79	79	79

(1) Operating Voltage Range: 187v min. - 253v max.

(2) HACR Type Circuit Breakers may be used.

(3) Requires 7/8" to 3/4" reducer from line to unit.

(4) Requires 7/8" to 1-1/8" reducer from line to unit.

HSA1(B,Q)E ACCESSORIES

Description	Part Number
Start Assist Kit - Provides additional starting torque for the compressor motor when operating with low line voltage or high operating temperatures.	912933
Fan Delay Kit (TDR) - 80-second fan delay.	918476
Insulated Pre-Charged Line Sets - A line set consists of a liquid line, an insulated suction line, service gaugeports, and the quick-connect coupling. 15, 20, 25, 30, 40, and 50 ft. lengths are available. Lines are factory pre-charged such that no additional refrigerant charge is required on matched systems.	
Outdoor Thermostat - Two-stage logic provides ability to lock out electric strips down to balance point and bring on in stages.	913852
Filter Kit, 18"	921784
Filter Kit, 24"	921785
Filter Kit, 28"	1006697
Coil Box, M1/M7	922594
Coil Box, E3/E4, Upflow	902976
Coil Box, E3/E4, Front Return	904067

PANEL REMOVAL AND REPLACEMENT INSTRUCTIONS

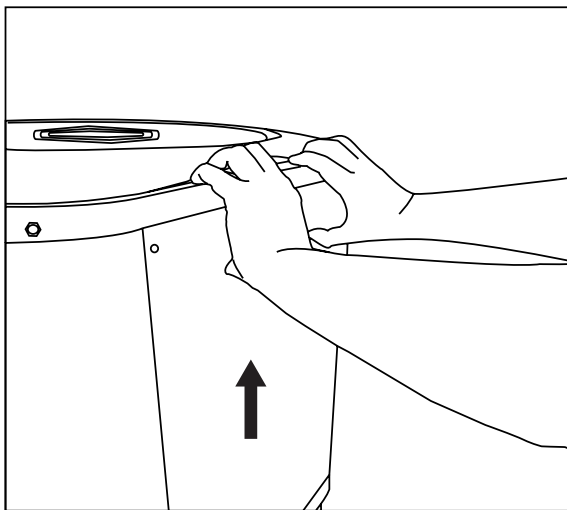

Removing Panels:

1. Remove screws.
2. Pull up on panel.
3. Rotate bottom of panel out.
4. Pull panel off.

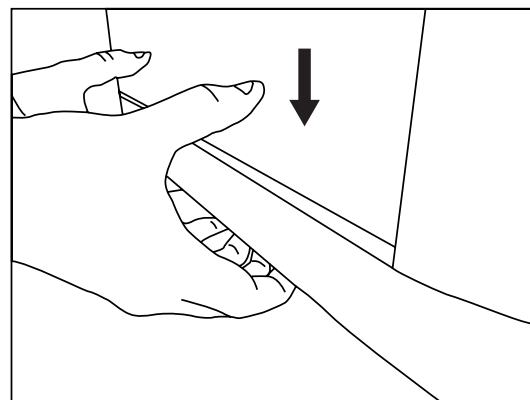
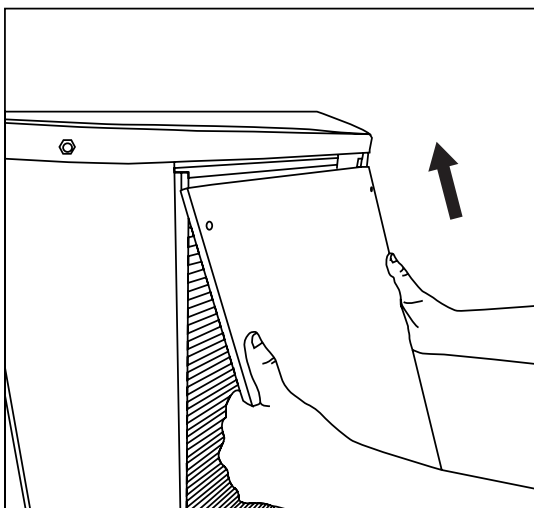
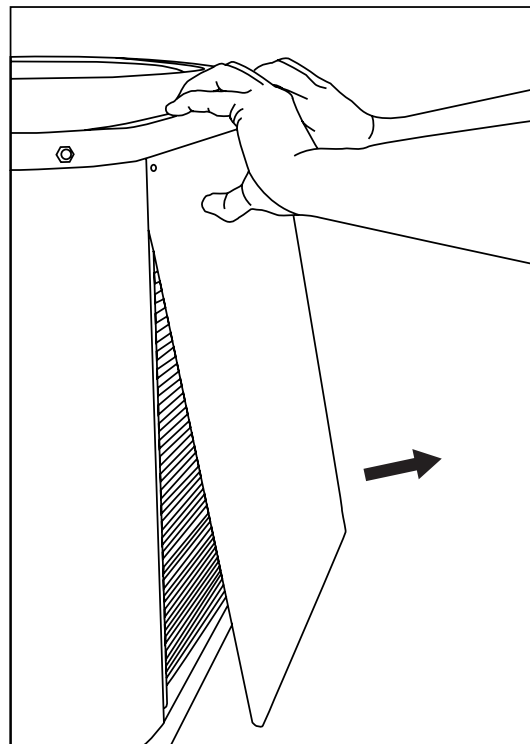

Reinstalling Panels:

1. Place panel back in towards top of unit.
2. Rotate bottom of panel inwards.
3. Push panel down until it fills gap at bottom of unit.
4. Replace screws.

SYSTEM COOLING CAPACITIES

14 SEER — Extra High Efficiency — Single Phase

With M1 & M7 Gas Furnace						
Outdoor Unit	Indoor Unit	Coil Height	Cooling Capacity	SEER	EER	SCFM
HSA1QE4M1SN24K	C8QAMX24U-B	18"	23400	14	12.2	780
HSA1QE4M1SN30K	C8QAMX30U-B	18"	29000	14	12.2	960
HSA1QE4M1SN36K	C8QAMX36U-B	18"	34,000	14	12.2	1200
HSA1QE4M1SN42K	CM4Q-R42U	18.5" *	39,500	14	12.2	1400
HSA1QE4M1SN42K	CM4Q-G42U	24" **	40,000	14	12.2	1400
HSA1QE4M1SN48K	CM4Q-L48U	18.5" *	45,000	14	11.7	1430
HSA1QE4M1SN48K	CM4Q-G48U	24" **	45,000	14	11.7	1430

HSA1BE4M1SN18K	C8(B,D)AMX24U-B	18"	18000	14	12.2	675
HSA1BE4M1SN24K	C8(B,D)AMX24U-B	18"	24000	14	12.2	700
HSA1BE4M1SN30K	C8(B,D)AMX30U-B	18"	29000	14	12.0	960
HSA1BE4M1SN36K	C8(B,D)AMX36U-B	18"	34,000	14	12.2	1200
HSA1BE4M1SN42K	CM4B-R42U	18.5" *	39,500	14	12	1400
HSA1BE4M1SN42K	CM4B-G42U	24" **	40,000	14	12	1400
HSA1BE4M1SN48K	CM4B-L48U	18.5" *	45,000	14	12	1430
HSA1BE4M1SN48K	CM4B-G48U	24" **	45,000	14	12	1430
HSA1BE4M1SN60K	CM4B-W60U	24.5" **	52,500	14	12	1490

* Requires M1/M7 18" Coil Box

** Requires M1/M7 24" Coil Box

With E3/E4 Furnace						
Outdoor Unit	Indoor Unit	Coil Height	Cooling Capacity	SEER	EER	SCFM
HSA1QE4M1SN24K	C8QAMX24U-B	18"	23400	14	12.2	700
HSA1QE4M1SN24K	C8QAMX30U-B	18"	29000	14	12.2	960
HSA1QE4M1SN36K	C8QAMX36U-B	18"	34,000	14	12.2	1200
HSA1QE4M1SN42K	CM4Q-R42U	18.5"	39,500	14	12.2	1400
HSA1QE4M1SN42K	CM4Q-G42U	24"	40,000	14	12.2	1400
HSA1QE4M1SN48K	CM4Q-L48U	18.5"	45,000	14	11.7	1430
HSA1QE4M1SN48K	CM4Q-G48U	24"	45,000	14	11.7	1430

HSA1BE4M1SN18K	C8(B,D)AMX24U-B	18"	18000	14	12.2	675
HSA1BE4M1SN24K	C8(B,D)AMX24U-B	18"	24000	14	12.2	700
HSA1BE4M1SN30K	C8(B,D)AMX30U-B	18"	29000	14	12.0	960
HSA1BE4M1SN36K	C8(B,D)AMX36U-B	18"	34,000	14	12.2	1200
HSA1BE4M1SN42K	CM4B-R42U	18.5"	39,500	14	12.2	1400
HSA1BE4M1SN42K	CM4B-G42U	24"	40,000	14	12	1400
HSA1BE4M1SN48K	CM4B-L48U	18.5"	45,000	14	12	1430
HSA1BE4M1SN48K	CM4B-G48U	24"	45,000	14	12	1430
HSA1BE4M1SN60K	CM4B-W60U	24.5"	52,500	14	12	1490

See current AHRI Directory for certified combinations and ratings.

www.ahridirectory.org



GENERAL TERMS OF LIMITED WARRANTY

Nortek Global HVAC LLC will furnish a replacement for any part of this product which fails in normal use and service within the terms and conditions of the warranty.

For complete details of the Limited Warranty, including applicable terms and conditions, see your local installer or contact the Nortek Global HVAC LLC warranty department for a copy.

Before purchasing this appliance, read important energy cost and efficiency information available from your retailer. Specifications and illustrations subject to change without notice and without incurring obligations. Printed in U.S.A (09/2017)