

INSTALLATION INSTRUCTIONS

Outdoor Thermostat Field Installation for 14 & 16 SEER Heat Pumps

IMPORTANT SAFETY INFORMATION

INSTALLER: Please read all instructions before servicing this equipment. Pay attention to all safety warnings and any other special notes highlighted in the manual. Safety markings are used frequently throughout this manual to designate a degree or level of seriousness and should not be ignored. **WARNING** indicates a potentially hazardous situation that if not avoided, could result in personal injury or death.

WARNING:

ELECTRICAL SHOCK, FIRE OR EXPLOSION HAZARD

Failure to follow safety warnings exactly could result in serious injury or property damage.

Improper servicing could result in dangerous operation, serious injury, death or property damage.

- Before servicing, disconnect all electrical power to the unit.
- When servicing controls, label all wires prior to disconnecting. Reconnect wires correctly.
- Verify proper operation after servicing.

14 & 16 SEER HEAT PUMPS

The instructions listed below describe how to properly install the outdoor thermostat that is required by HUD in split system and packaged unit heat pump applications. See Figure 1.

NOTE: Please refer to the installation instructions supplied with the unit for proper wiring of the outdoor thermostat. All wiring and quick connect terminals needed to install the outdoor thermostat are field supplied. Thermostat terminal designations may vary.

1. Using a 5" long wire (with 1/4" quick connect receptacle terminal on both ends), connect one end of the quick connect terminal to the outdoor thermostat (ODT) and connect the other end to the W2 IN terminal on the defrost board.
2. Place a 1/4" quick connect receptacle terminal to the field thermostat wire W2 from the thermostat. Connect the quick connect terminal to the outdoor thermostat (ODT).
3. Using a cable tie, bundle the suspended outdoor thermostat to the low voltage wire bundle in the control box.

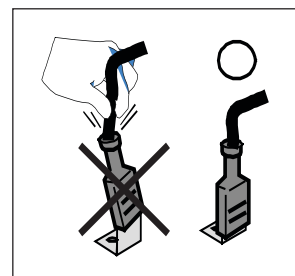
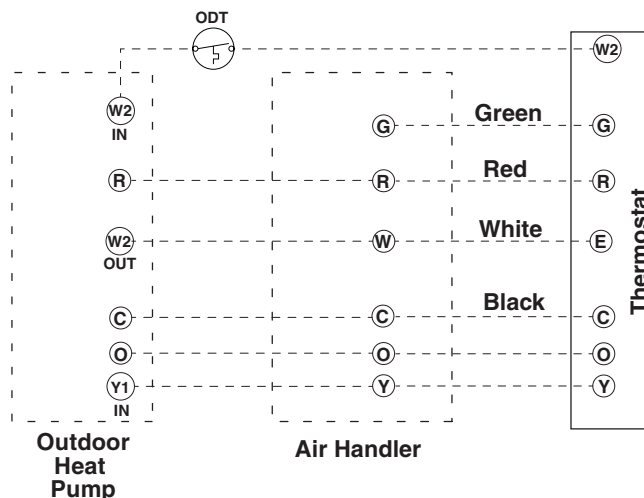

Figure 1. Indoor Thermostat Hookup

13 SEER HEAT PUMPS

The instructions listed below describe how to properly install the outdoor thermostat on 13 SEER heat pumps.

1. Connect one side of the wire (1) to a terminal on the Outdoor Thermostat (2). See Figure 2.
2. Connect the terminal adapter (3) to the free terminal on the ODT (2).
3. Connect the free end of the wire (1) to the "W2" on the Defrost Board and the terminal (3) to the "E" on the Defrost Board.

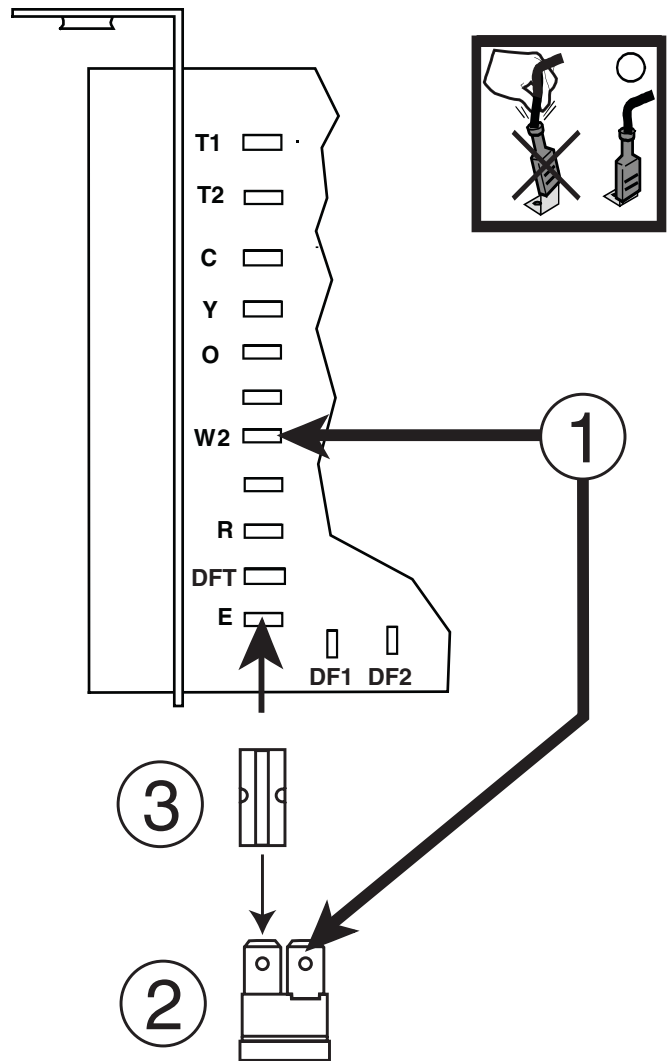

Figure 2. Outdoor Thermostat Hookup

