

## E7ED Series Electric Furnace - A2L Retrofit Kit

# INSTALLATION INSTRUCTIONS

### Downflow Models

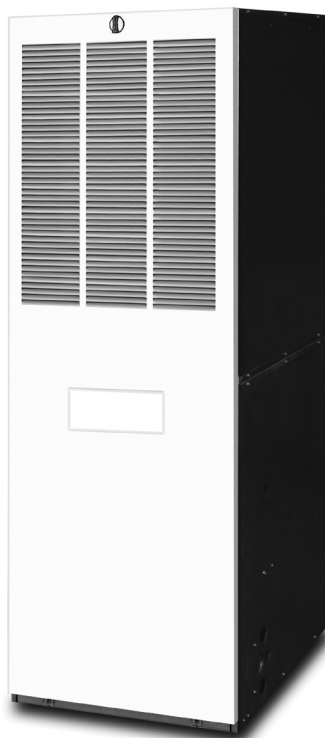

**E7ED DOWNFLOW**

### **⚠ WARNING**

#### **ELECTRICAL SHOCK, FIRE OR EXPLOSION HAZARD**

**Failure to follow safety warnings exactly could result in serious injury, death or property damage.**

**Improper servicing could result in dangerous operation, serious injury, death or property damage.**

- **Before servicing, disconnect all electrical power to Appliance both poles.**
- **When servicing controls, label all wires prior to disconnecting. Reconnect wires correctly.**
- **Verify proper operation after servicing.**

**DO NOT DESTROY. PLEASE READ CAREFULLY &  
KEEP IN A SAFE PLACE FOR FUTURE REFERENCE.**

### **ATTENTION INSTALLERS:**

It is your responsibility to know this product better than your customer. This includes being able to install the product according to strict safety guidelines and instructing the customer on how to operate and maintain the equipment for the life of the product. Safety should always be the deciding factor when installing this product and using common sense plays an important role as well. Pay attention to all safety warnings and any other special notes highlighted in the manual. Improper installation of the Appliance or failure to follow safety warnings could result in serious injury, death, or property damage.

These instructions are primarily intended to assist qualified individuals experienced in the proper installation of this appliance. Some local codes require licensed installation/service personnel for this type of equipment. Please read all instructions carefully before starting the installation. Return these instructions to the customer's package for future reference.

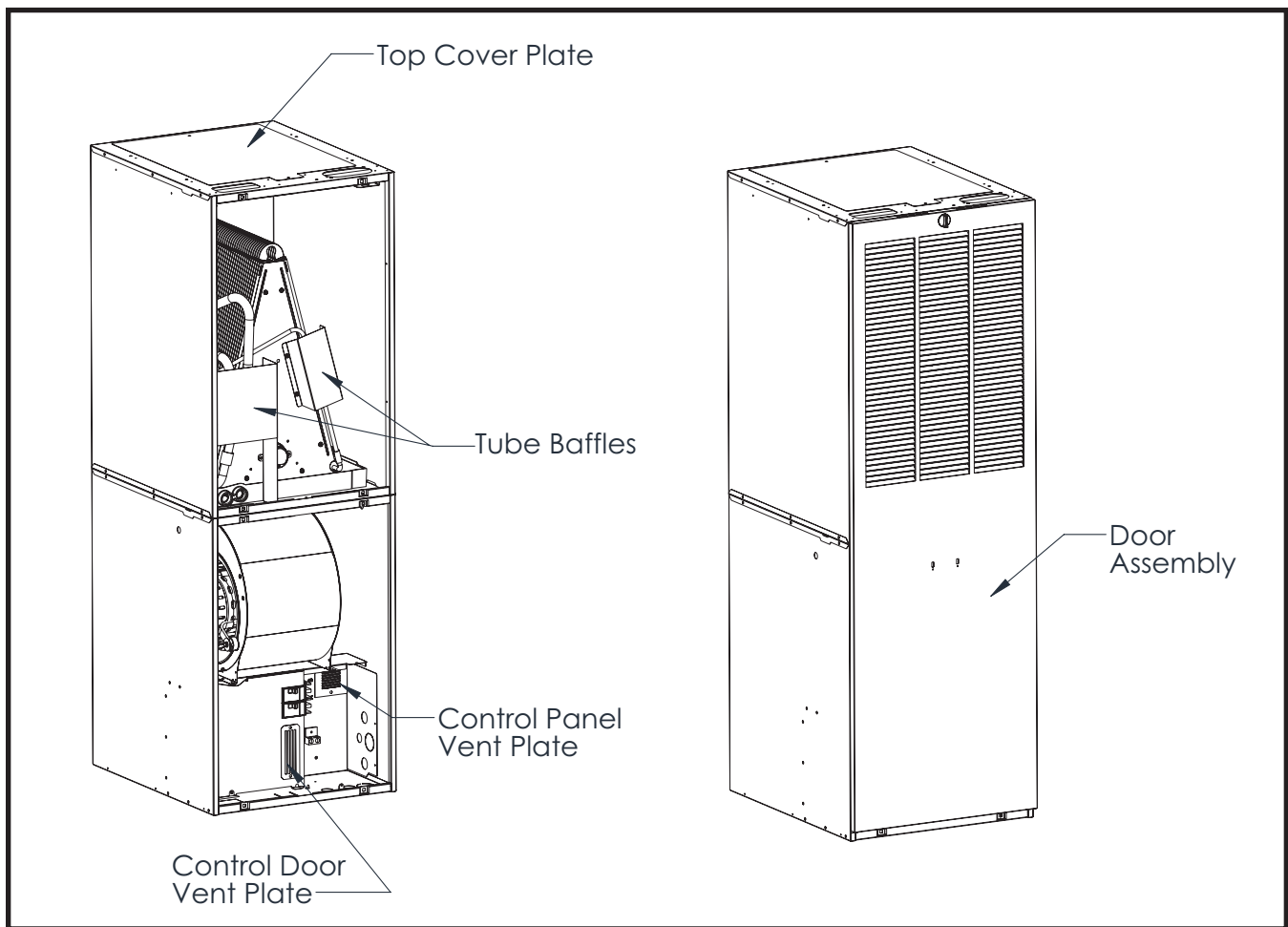

**Figure 1. E7ED A2L Kit Part List**

To make E7ED models built before August 2024 compatible with A2L refrigerant and be able to use C85 R454B indoor coil with them, this retrofit kit is provided. Before installing C85 A2L indoor coil please read C85 installation instructions carefully.

In this kit you have the following parts (Figure 1):

1. Control Door Vent Plate
2. Control Panel Vent Plate
3. Louvered Door Assembly
4. Tube Baffles
5. Top Cover Plate
6. Cutout Templates
7. Retrofitted Label

**Follow these steps to make the furnace A2L compatible:**

1. Disconnect all power to the unit.
2. Remove the front panel.

**Installation of the Tube Baffles:**

1. Install the right baffle as shown in Figure 2 and secure with 2 of the supplied fasteners.
2. Install the left baffle as shown in Figure 3 and secure with 2 of the supplied fasteners.

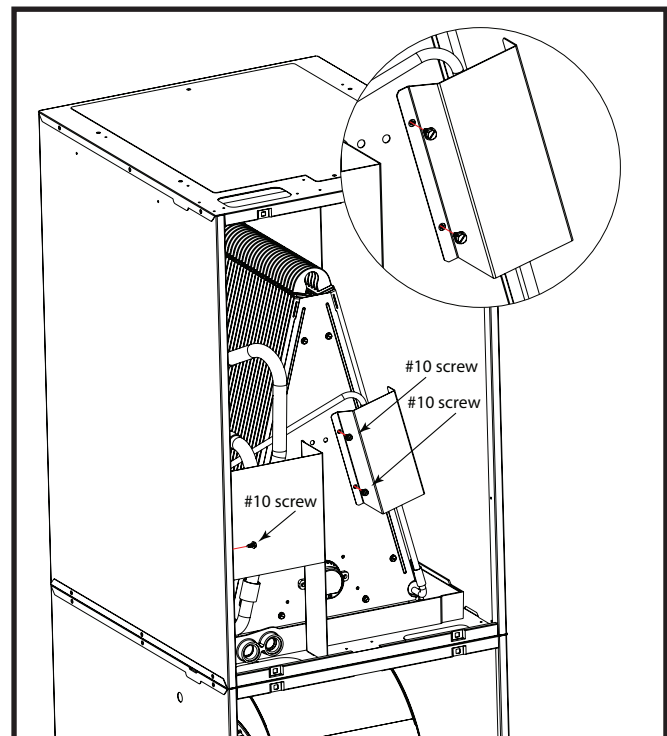

**Figure 2. Right Baffle Fastened with Screws**

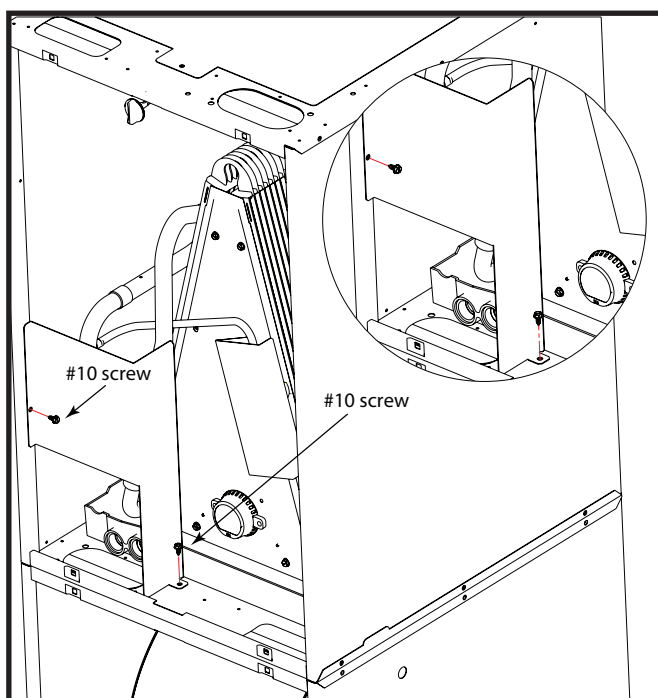

**Figure 3. Left Baffle Fastened with Screws**

**Installation of the Control Panel Plate (See Figure 4):**

1. Use template 1048542 to create a cutout in the control panel in the top right corner.
2. Use two self-tapping screws to secure the vent plate to the control panel over the cutout.
3. Verify the plate is secure.
4. Verify the cutout is fully covered by the vent plate with the slots on the vent plate over the cutout to allow for ventilation.

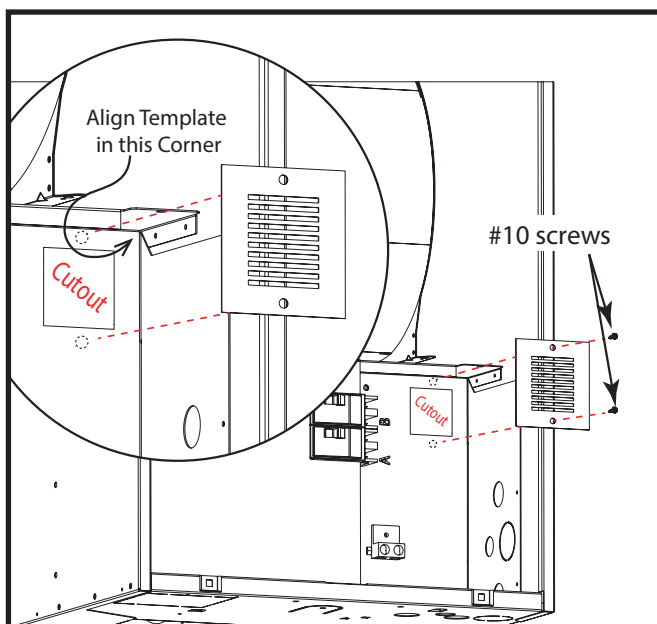

**Figure 4. Control Panel Vent Plate**

**Installation of the Control Door Plate (See Figure 5):**

1. Use template 1048997 to create a cutout in the control door in the bottom right corner.
2. Use two self-tapping screws to secure the vent plate to the control panel over the cutout.
3. Verify the plate is secure.
4. Verify the cutout is fully covered by the vent plate with the slots on the vent plate over the cutout to allow for ventilation.

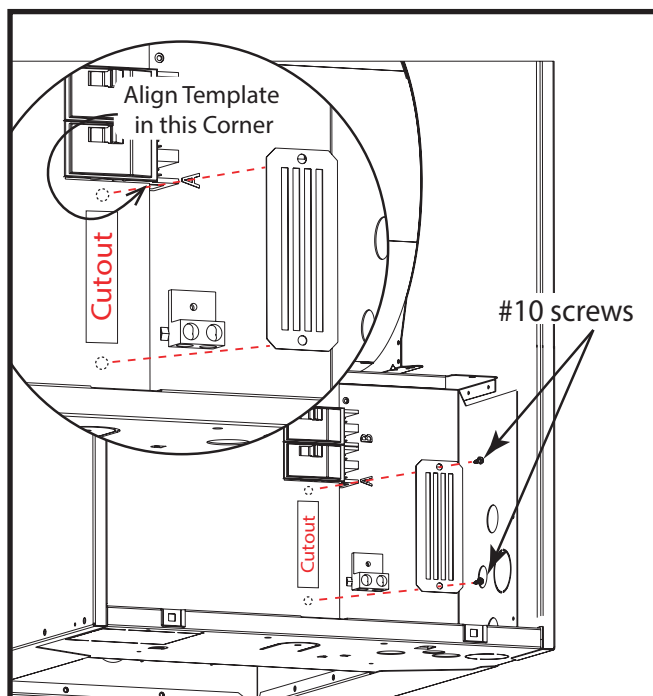

**Figure 5. Control Door Vent Plate**

**Installation of the Top Cover Plate (See Figure 6):**

1. Secure the top cover plate on the top pan with two #10 screws provided.

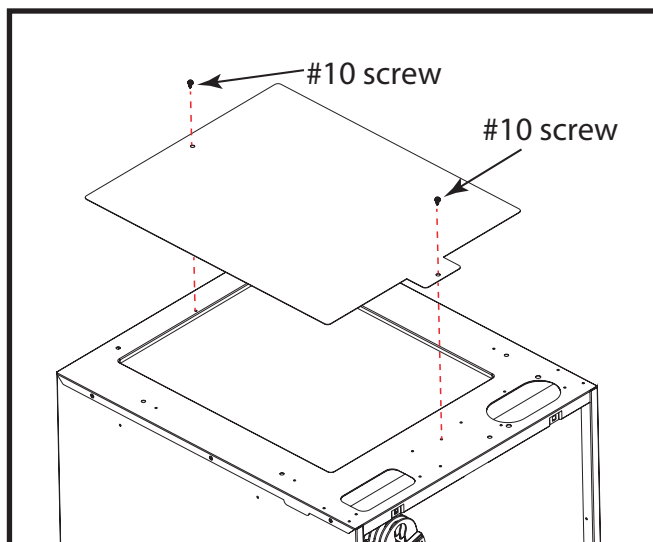

**Figure 6. Top Cover Plate**

**Installation of the Louvered Door (See Figure 7):**

1. Replace the existing louvered door with the new louvered door supplied in the kit.

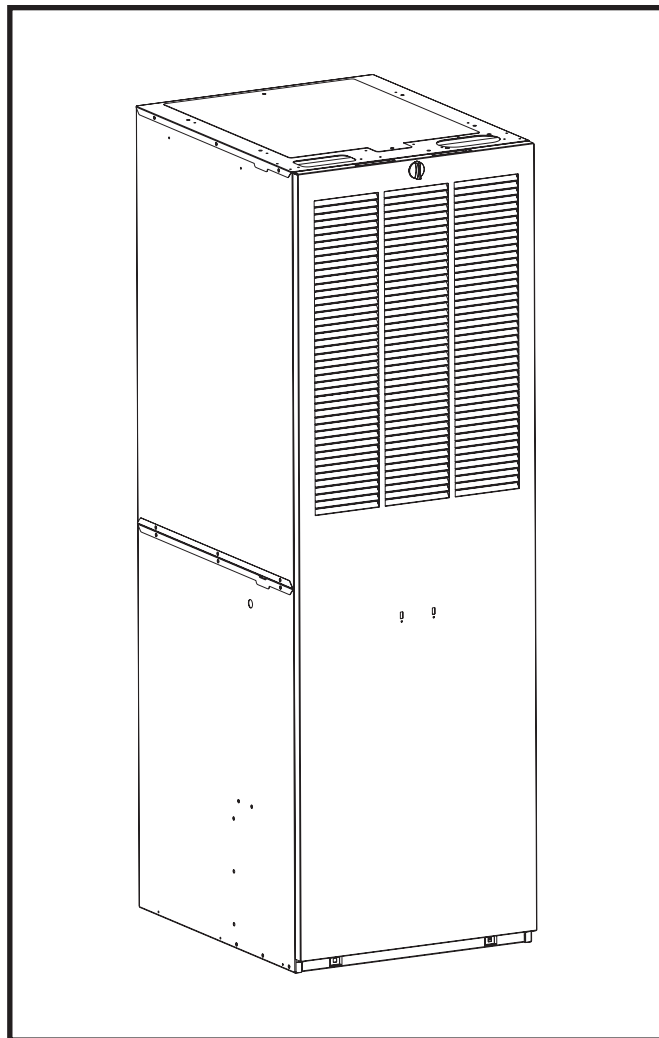

**Figure 7. Louvered Door**

**Apply Retrofitted Label**

1. Verify all modifications are complete.
2. Apply “retrofitted label” 1049101 to the outside of the door.

**NOTE: After all modifications are complete and verified, reconnect power.**

