

## REPLACEMENT PARTS LIST

SINGLE PACKAGE HEAT PUMP  
VQ6SE SERIES  
208 / 230V, 14 SEER, SINGLE PHASE MODELS



## IMPORTANT

- This document is primarily intended to assist qualified individuals experienced in the proper repair or servicing of this appliance. Only factory authorized parts or accessory kits may be used with this product. Improper installation, service, adjustment, or maintenance may cause explosion, fire, electrical shock or other hazardous conditions which may result in personal injury or property damage.
- Some local codes require licensed installation / service personnel to service this type of equipment. Under no circumstances should the equipment owner attempt to install parts or service this equipment. Failure to comply with this warning could result in property damage, personal injury, or death.

**VQ6SE SINGLE PACKAGE HEAT PUMP  
208 / 230V, SINGLE PHASE, 14 SEER MODELS**

DESCRIPTION	VQ6SE-X24K	VQ6SE-X30K	VQ6SE-X36K	VQ6SE-X42K	VQ6SE-X48K	VQ6SE-X60K
	1006591V	1006592V	1006593V	1006594V	1006595V	1006596V
ACCUMULATOR	668853R	668853R	668853R	668854R	668854R	668854R
AMBIENT SENSOR	626551R	626551R	626551R	626551R	626551R	626551R
BASE RAIL (LONG)	277552R	277552R	277552R	277552R	277552R	277552R
BASE RAIL (SHORT)	277551R	277551R	277551R	277551R	277551R	277551R
BLOWER HOUSING (9/10X10)	297214R	297214R	297214R	297214R	297214R	297214R
BLOWER MOTOR (1/2 HP)	1006529R	1006534R	1006540R	1006544R	—	—
BLOWER MOTOR (3/4 HP)	—	—	—	—	1006551R	1006556R
BLOWER RELAY COIL (240V)	622180R	622180R	622180R	622180R	622180R	622180R
BLOWER WHEEL (10 X 10)	667207R	667207R	667207R	667207R	667207R	667207R
CAPACITOR (40/5/370)	01-0084	01-0084	—	—	—	—
CAPACITOR (45/7.5/370)	—	—	01-0271	01-0271	—	—
CAPACITOR (70/7.5/370)	—	—	—	—	01-0278	—
CAPACITOR (80/7.5/370)	—	—	—	—	—	01-0279
CHARGING PORT CORE (NOT SHOWN)	662103R	662103R	662103R	662103R	662103R	662103R
COIL GUARD (FORMED)	2A8453R	2A8453R	2A8453R	2A8454R	2A8454R	2A8454R
COMPRESSOR (ZP21K5E)	921423	—	—	—	—	—
COMPRESSOR (ZP25K5E)	—	921425	—	—	—	—
COMPRESSOR (ZP31K5E)	—	—	921427	—	—	—
COMPRESSOR (ZP39K5E)	—	—	—	921465	—	—
COMPRESSOR (ZP42K5E)	—	—	—	—	921466	—
COMPRESSOR (ZP54K5E)	—	—	—	—	—	918873
CONTACTOR (1 POLE, 25A)	1014863R	1014863R	—	—	—	—
CONTACTOR (1 POLE, 32A)	—	—	1014864R	1014864R	—	—
CONTACTOR (1 POLE, 40A)	—	—	—	—	1014865R	1014865R
CORNER POST	D09996BR	D09996BR	D09996BR	D09997BR	D09997BR	D09997BR
CRANK CASE HEATER (NOT SHOWN)	632677R	632677R	632677R	632677R	632677R	632677R
DEFROST BOARD	920806	920806	920806	920806	920806	920806
DEFROST SENSOR	624740R	624740R	624740R	624740R	624740R	624740R
DRAIN PAN	669190R	669190R	669190R	669190R	669190R	669190R
DRAIN TUBE	663833R	663833R	663833R	663833R	663833R	663833R
DROP-IN ORIFICE	263210R	263210R	295481R	263210R	295481R	295481R
FAN BLADE (20")	667278R	667278R	—	667278R	—	—
FAN BLADE (24")	—	—	667351R	—	667319R	667319R
FAN MOTOR (1/5 HP)	622080	622080	—	—	—	—
FAN MOTOR (1/4 HP)	—	—	622066	622066	622066	622066
FILTER DRIER (8 IN <sup>3</sup> )	669762R	669762R	669762R	669762R	669762R	669762R
FUSE (3 AMP) (NOT SHOWN)	632261R	632261R	632261R	632261R	632261R	632261R
GROUNDING LUG	632235R	632235R	632235R	632235R	632235R	632235R
HEX NUT (BLACK) (NOT SHOWN)	606261R	606261R	606261R	606261R	606261R	606261R
HIGH PRESSURE SWITCH (NOT SHOWN)	632473R	632473R	632473R	632473R	632473R	632473R
INDOOR COIL	294911R	1006536R	294911R	—	—	294921R
INDOOR DISTRIBUTOR (3 CIRCUIT) (NOT SHOWN)	663913R	663913R	663913R	—	—	—
INDOOR DISTRIBUTOR (6 CIRCUIT) (NOT SHOWN)	—	—	—	664410	664351	664351
LOW PRESSURE SWITCH (NOT SHOWN)	1023983R	1023983R	1023983R	1023983R	1023983R	1023983R

Please specify the correct Model No., Serial No, and part number(s) when ordering parts from the nearest authorized dealer or service center.

**VQ6SE SINGLE PACKAGE HEAT PUMP  
208 / 230V, SINGLE PHASE, 14 SEER MODELS**

DESCRIPTION	VQ6SE-X24K	VQ6SE-X30K	VQ6SE-X36K	VQ6SE-X42K	VQ6SE-X48K	VQ6SE-X60K
	1006591V	1006592V	1006593V	1006594V	1006595V	1006596V
MOLDED PLUG (NOT SHOWN)	634715R	634715R	634715R	634715R	634715R	634715R
MOTOR MOUNT KIT	668926R	668926R	668926R	668926R	668926R	668926R
OUTDOOR COIL	D06262R	D06262R	D06262R	D06265R	D06266R	D06266R
OUTDOOR DISTRIBUTOR (4 CIRCUIT) (NOT SHOWN)	663581R	663581R	663581R	—	—	—
OUTDOOR DISTRIBUTOR (5 CIRCUIT) (NOT SHOWN)	—	—	—	663582R	—	—
OUTDOOR DISTRIBUTOR (8 CIRCUIT) (NOT SHOWN)	—	—	—	—	663586R	663586R
OUTDOOR RESTRICTOR (.047)	664047R	—	—	—	—	—
OUTDOOR RESTRICTOR (.052)	—	664052R	—	—	—	—
OUTDOOR RESTRICTOR (.057)	—	—	664057R	—	—	—
OUTDOOR RESTRICTOR (.059)	—	—	—	664059R	—	—
PANEL MOUNT FITTING	664696R	664696R	664696R	664696R	664696R	664696R
REVERSING VALVE	669465R	669465R	669465R	1013956R	1013956R	1013956R
REVERSING VALVE COIL	669472R	669472R	669472R	669471R	669471R	669471R
SERVICE PORT CAP (BRASS NUT) (NOT SHOWN)	663818R	663818R	663818R	663818R	663818R	663818R
SET OF WIRES (NOT SHOWN)	1006619R	1006619R	1006619R	1006619R	1006619R	1006619R
SWIVEL CONNECTOR (NOT SHOWN)	664194R	664194R	664194R	664194R	—	—
THERMAL EXPANSION VALVE (INDOOR) (NOT SHOWN)	664343R	664344R	664343R	664346R	664348R	664347R
THERMAL EXPANSION VALVE (OUTDOOR) (NOT SHOWN)	—	—	—	—	664346R	664348R
TOP GRILLE (BLACK)	669404R	669404R	669335R	669404R	669335R	669335R
TOP PAN	292442R	292442R	M0034710R	292442R	M0034710R	M0034710R
TOUCH-UP PAINT (STERLING GREY) (NOT SHOWN)	904038	904038	904038	904038	904038	904038
TRANSFORMER	621709R	621709R	621709R	621709R	621709R	621709R

Please specify the correct Model No., Serial No, and part number(s) when ordering parts from the nearest authorized dealer or service center.

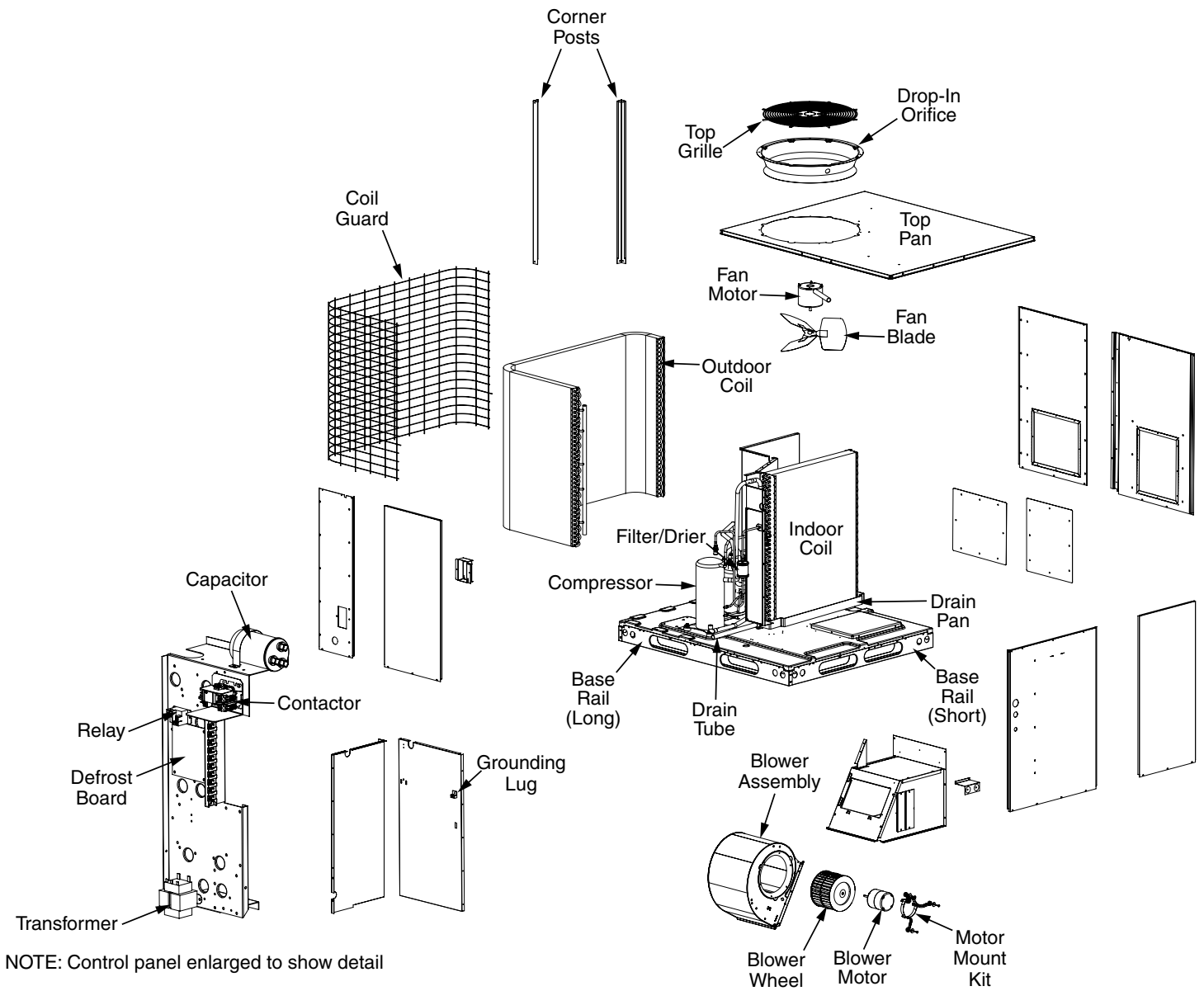

NOTE: Control panel enlarged to show detail

