



Universal HVAC Parts & Accessories

REPLACEMENT PARTS LIST

FLEX MATCH SYSTEM

OUTDOOR UNIT

GXH30(8.8)FMK4DH

ITEM #	COMPONENT
1	TOP COVER SUB-ASSY
2	LEFT HANDLE
3	LEFT SIDE PLATE
4	FAN MOTOR
5	AXIAL FLOW FAN
6	FRONT PANEL ASSY
7	FRONT GRILL
8	FRONT SIDE PLATE
9	ELECTRICAL HEATER
10	CHASSIS SUB-ASSY
11	COMPRESSOR
12	ELECTRIC HEATER (COMPRESSOR)
13	COMPRESSOR GASKET
14	SENSOR SUB-ASSY
15	COMPRESSOR OVERLOAD PROTECTOR (EXTERNAL)
16	VALVE SUPPORT ASSY
17	STRAINER A
18	ELECTRONIC EXPANSION VALVE ASSY
19	ELECTRIC EXPAND VALVE FITTING
20	CUT OFF VALVE
21	CUT OFF VALVE
22	WIRING COVER SUB-ASSY
23	HANDLE ASSY
24	RIGHT SIDE PLATE
25	ELECTRIC EXPAND VALVE FITTING
26	ELECTRIC EXPAND VALVE FITTING
27	WIRING CLAMP
28	ELECTRIC EXPAND VALVE FITTING
29	BIDIRECTION STRAINER
30	GAS-LIQUID SEPARATOR ASSY
31	REACTOR
32	REAR GRILL
33	CLAPBOARD
34	CABLE CROSS LOOP
35	CONDENSER ASSY
36	CONDENSER SUPPORT PLATE
37	CONDENSER ASSY
38	PRESSURE PROTECT SWITCH
39	4-WAY VALVE
40	4-WAY VALVE ASSY
41	MAGNET COIL
42	ELECTRIC BOX ASSY
43	WIRE CLAMP
44	TERMINAL BOARD
45	WIRE CLAMP
46	INSULATION GASKET
47	TERMINAL BOARD
48	MAGNETIC RING
49	CABLE CROSS LOOP
50	MAIN BOARD
51	ELECTRIC BOX
52	RADIATOR
53	SENSOR SUB-ASSY

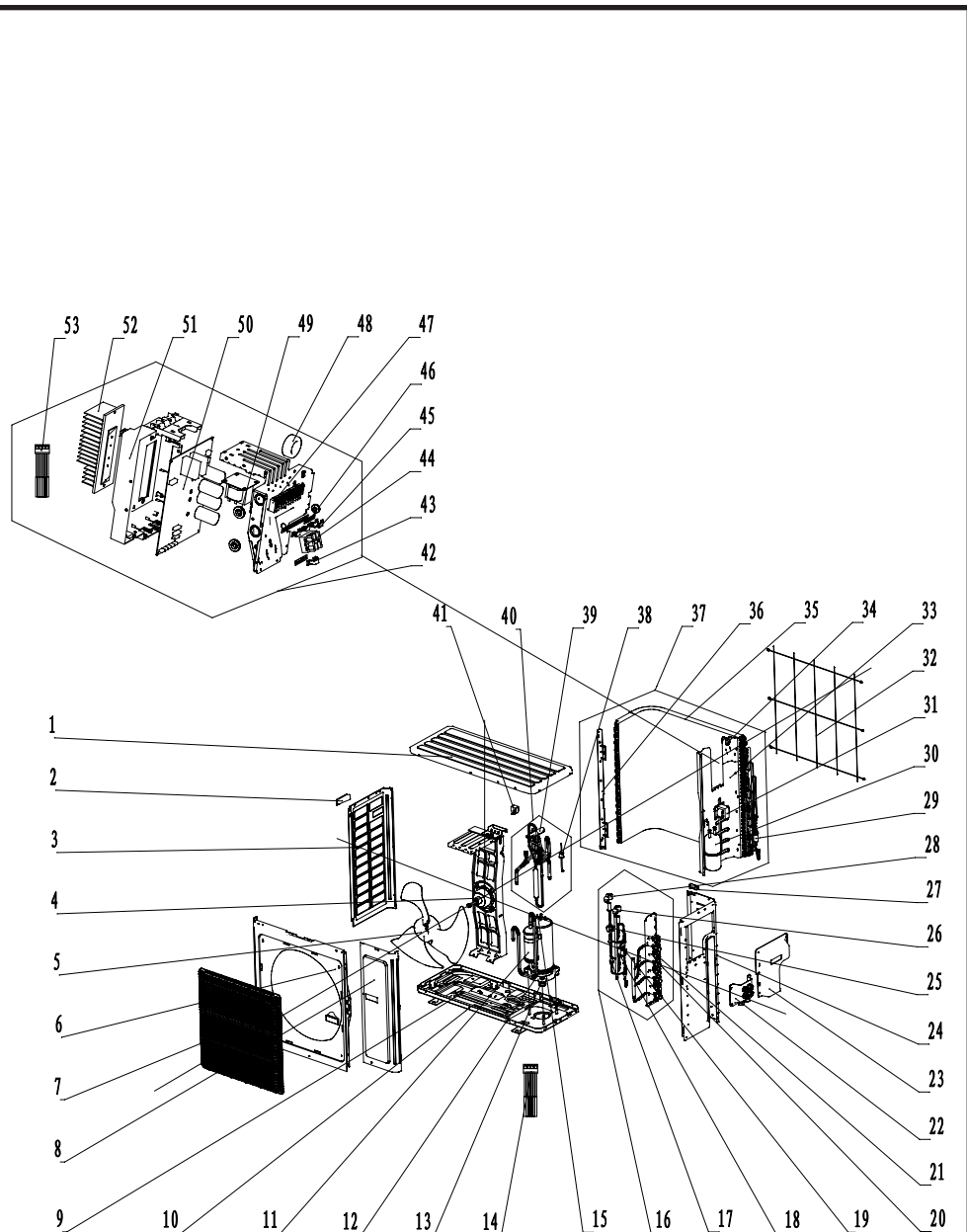

GXH30(8.8)FMK4DH

	PART DESCRIPTION	PART CODE	NORTEK PART NUMBER
1	Top Cover Sub-Assy	01264100013	1032541
2	Left Handle	26235401	1032464
3	Left Side Plate	01305043P	1032363
4	Fan Motor	15702802	1008278
5	Axial Flow Fan (Fan Blade)	10335014	1028749
6	Front Panel Assy	0153501405	1025080
7	Front Grill	01473050	1028856
8	Front Side Plate	01305086P	1025116
9	Electrical Heater (Chassis)	765100047	1032542
10	Chassis Sub-Assy	01284100112P	1032543
11	Compressor	00205200003	1014116
12	Electric Heater (Crankcase Heater)	7651873215	1032523
13	Compressor Gasket (Grommet)	76713066	1008256
14	Port Temperature Sensor Assembly*	39004100005G	1008288
15	Compressor Overload Protector (External)	00180030	1025119
16	Valve Support Assy	30163000003	1044974
16	Valve Support Assy NOTE: For Units Manufactured Before 2015	07133775	1032545
17	Strainer A	07210022	1032546
	Electronic Expansion Valve Assy (EEV Assy)	30174000014	1044985
18	Electronic Expansion Valve Assy (EEV Assy) NOTE: For Units Manufactured Before 2015	07133778	1014108
19	Electric Expansion Valve And Fitting (Black) (EEV Coil Port A)	4304413243	1044973
19	Electric Expansion Valve And Fitting (Black) (EEV Coil Port A) NOTE: For Units Manufactured Before 2015	4300876720	1014109
20	Cut Off Valve (3/8-in Gas/Suction Service Valve) (Ports A, B, C, & D)	071302391	1025095
21	Cut Off Valve (1/4-in Liquid Line Service Valve) (Ports A, B, C, & D)	07130239	1028721
22	Wiring Cover Sub-Assy	01264100034	1032528
23	Handle Assy	02204100008	1032529
24	Right Side Plate	0131410000901P	1032527
25	Electric Expansion Valve And Fitting (Green) (EEV Coil Port B)	4304413242	1044972
25	Electric Expansion Valve And Fitting (Green) (EEV Coil Port B) NOTE: For Units Manufactured Before 2015	4300876719	1014110
26	Electric Expansion Valve And Fitting (Blue) (EEV Coil Port C)	4304413241	1044971
26	Electric Expansion Valve And Fitting (Blue) (EEV Coil Port C) NOTE: For Units Manufactured Before 2015	4300876718	1014111
27	Wiring Clamp	26115004	1032440

*Temperature Sensor contains Port A, B, C, & D (Liquid & Suction).

GXH30(8.8)FMK4DH

	PART DESCRIPTION	PART CODE	NORTEK PART NUMBER
	Electric Expansion Valve And Fitting (Red) (EEV Coil Port D)	4304413222	1014112
28	Electric Expansion Valve And Fitting (Red) (EEV Coil Port D) NOTE: For Units Manufactured Before 2015	4300876717	1032580
29	Bidirection Strainer	07220016	1032550
30	Gas-liquid Separator Assy	07225017	1032551
31	Reactor	43130186	1032552
32	Rear Grill	01574100003	1032531
33	Clapboard	01244100003	1032554
34	Cable Cross Loop	76512008	1032555
35	Condenser Coil	01124100007	1025073
36	Condenser Support Plate	01175092	1028784
37	Condenser Coil Assy	01124100118	1032502
38	Pressure Protect Switch	4602000902	1008292
39	4-way Valve (Reversing Valve)	4300008201	1014113
40	4-Way Valve Assy (Reversing Valve Assy)	04045200071	1014114
41	Magnet Coil (Reversing Valve Coil)	4300040072	1014115
42	Electric Box Assy	01395200378	1032557
43	Wire Clamp	71010005	1032558
44	Terminal Block (2 Position)	42018094	1032559
45	Wire Clamp	71010003	1028737
46	Insulation Gasket	70410503	1032560
47	Terminal Block (3 Position)	420111041	1032562
48	Magnetic Ring	49010109	1032563
49	Cable Cross Loop	76510021	1032564
50	Main Control Board	30228000026	1008282
51	Electric Box (Box Only)	26904100013	1032565
52	Radiator (Heat Sink)	49010252	1025114
53	Temperature Sensor Sub-Assy (Discharge, Coil, Ambient)**	39008000017G	1008201
	Adapter Pipes 3/8-in to 5/8-in (Not Shown)	6654100009	1017000
	Adapter Pipes 3/8-in to 1/2-in (Not Shown)	6654100013	1017001
	Adapter Pipes 1/4-in to 3/8-in (Not Shown)	6654104	1017002

**Temperature Sensor contains Discharge, Condenser Coil and Ambient sensors.

