

MPE-36R

MERIT® PLUS ELECTRIC FIREPLACE

Framing Dimensions

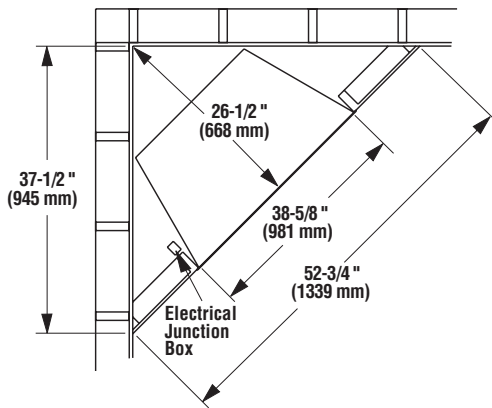

Corner View

Note: Framing dimensions are calculated for a nailing flange depth of 1/2"

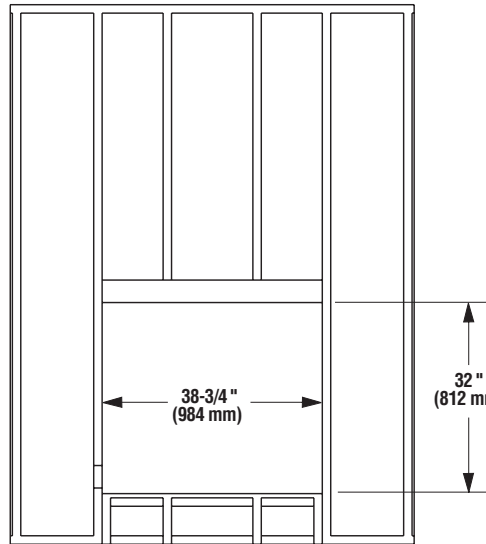

Front View

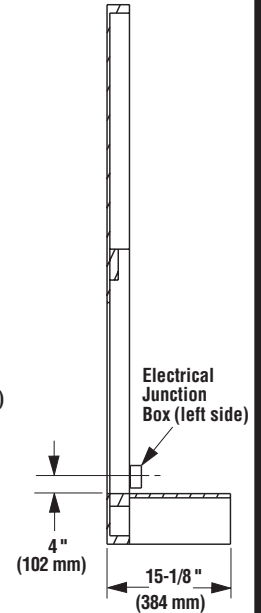

Side View

Product Reference Information

Cat. No. H1534
Model: MPE-36R
Description: Merit Plus Electric Fireplace,
36" Radiant
Shipping Weight: 90 lb.'s (41 KG)
Packaging:
44-3/4" x 19-1/2" x 34-1/4"
(1135 mm x 495 mm x 870 mm)
17.30 cu. ft.

Power Requirements:
(120 Volt, 60 Hz.)
Rated Wattage - 1600 Watts
Amperage - 13.33 Amps
(240 Volt, 60 Hz.)
Rated Wattage - 3000 Watts
Amperage - 12.5 Amps
Blower CFM: 83 CFM
(120 V): 5,461 BTU/HR
(240 V): 10,239 BTU/HR

Locations

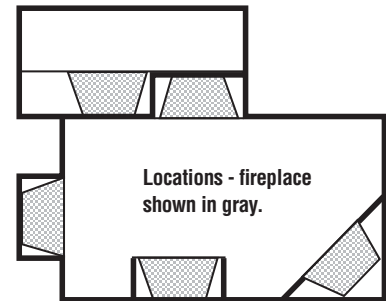

Locations - fireplace shown in gray.

Fireplace Dimensions

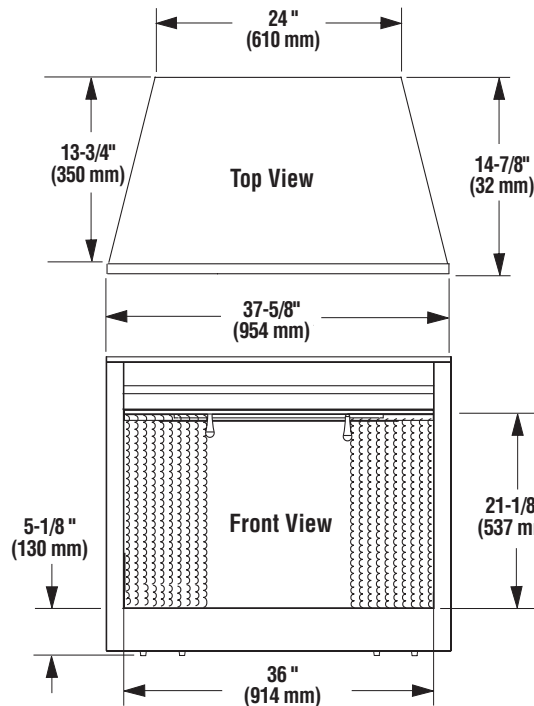
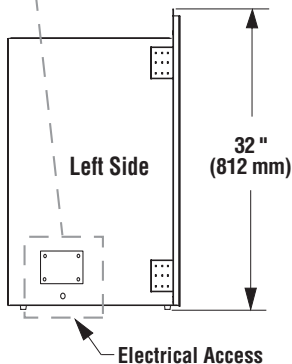
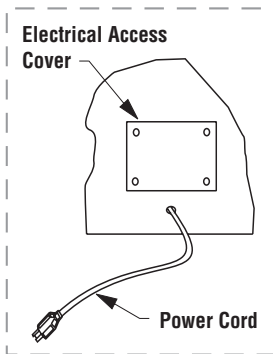

Top View

Front View

Listing



Report # 214173-1482763

This appliance has been tested in accordance with UL 2021 and CSA C22.2 No. 46-M198 standards for fixed and location dedicated electric room heaters.

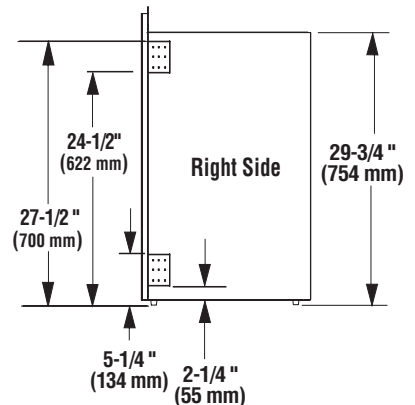

Right Side

LENNOX
HEARTH PRODUCTS

MPE-36R

Clearances to Combustibles

Clearances - This appliance is an electric fireplace designed to be framed in with combustible materials (up to the edge of the appliance). A drywall lip at the top of the fireplace and 4 nailing flanges on the sides of the appliance is provided to facilitate installation.

Minimum Clearances Inches (millimeters)	
Back	0 (0)
Sides	0 (0)
Top	0 (0)
Floor	0 (0)

Mantel Clearance: Combustible and Non-combustible mantels may be installed at any height above the top of the face of fireplace.

Hearth Protection: A hearth is not required, but it is recommended for aesthetic purposes.

Fireplace Manual Controls

Controls - The Merit Plus Electric Fireplace is provided with an Infrared light Remote Control. All functions of the fireplace can be controlled through the remote control. Note: The Effective range of the remote control is up to approximately 26 feet (8 meters). Manual Controls are also provided on the appliance.

Manual Control Panel

Main Power On/Off (rear most switch)



Heater On/Off (center switch)



Flame / Ember On/Off (front most switch)



Fireplace Features & Optional Accessories

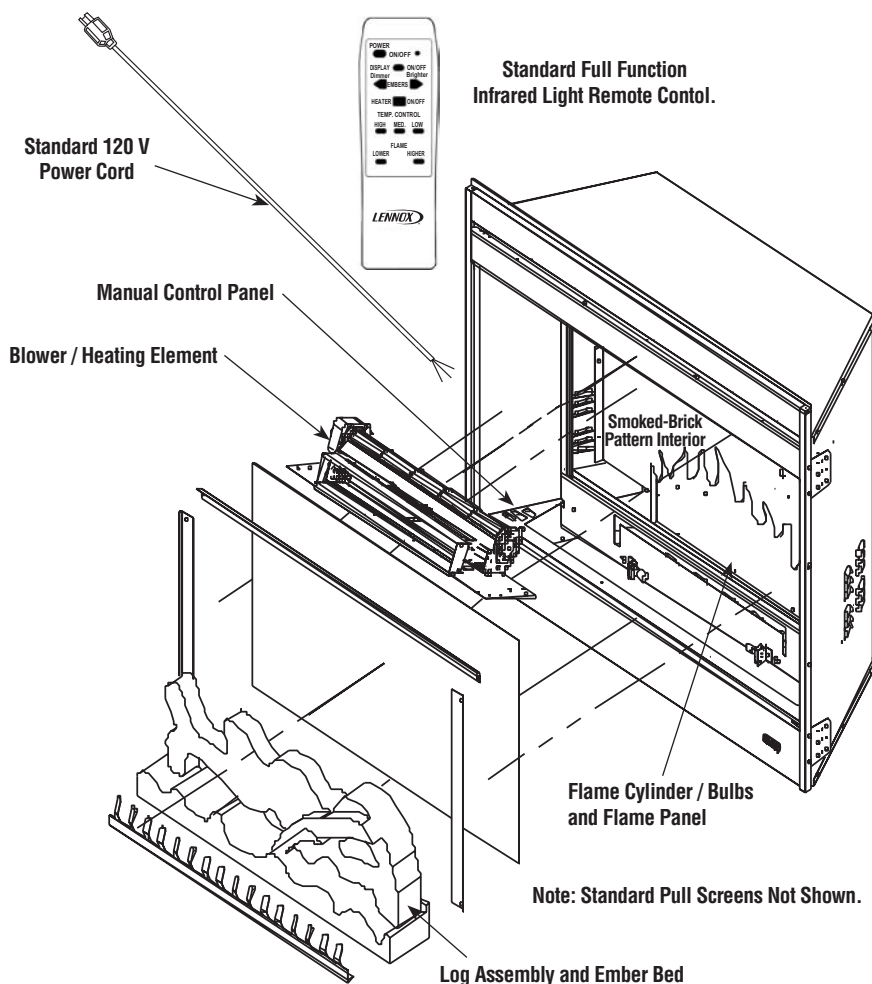

Standard Features

- Oak log set and glowing ember bed.
- Smoked-Brick pattern interior.
- Adjustable flame height & ember intensity.
- Operable pull screens.
- 5000 BTU (120 V) or 10,000 BTU (240 V) heater.
- Full featured remote control.
- Wall switch and thermostat ready.
- 120 V Power Cord.

Options

- Wall switch
- Wall thermostat
- Glass Enclosure Kits (black, brass & stainless)
- Trim Kits (black, brass & stainless on bronze)
- Complete Front Face Kits (mission style & interlocking arch)

Specifications and clearances are subject to change without notice. Refer to Installation Manual before installation of these appliances for updated dimensions and instructions.

Printed in U.S.A. © 2004 by LENNOX HEARTH PRODUCTS
P/N 775,558M REV. A 06/2006

LENNOX
HEARTH PRODUCTS

MERIT® PLUS
ELECTRIC FIREPLACE